

# PLAT OF SURVEY

LOTS 6245-6257, AND 6280-6281 OF BLOCK 109 AND  
LOTS 9649-9653 OF BLOCK 175 OF LAKE COMO BEACH SUBDIVISION

LOCATED IN PART OF THE SW 1/4 OF THE SE 1/4 OF SECTION 21, AND PART OF  
THE NW 1/4 OF THE NE 1/4 OF SECTION 28, ALL IN TOWN 2 NORTH, RANGE 17 EAST,  
TOWN OF GENEVA, WALWORTH COUNTY, WISCONSIN

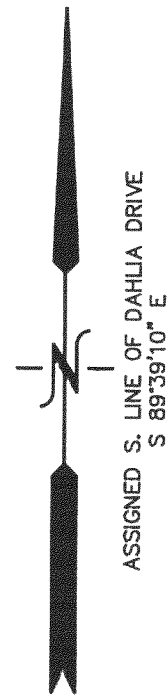

28

8mf

NOTE:  
WISCONSIN SOUTHERN GAS COMPANY, INC. EASEMENT REC. ON OCTOBER 24, 1955  
IN VOLUME 489 OF DEEDS ON PAGE 541 AS DOCUMENT NO. 475581 GIVES THE  
RIGHT TO LAY, CONSTRUCT, OPERATE, AND MAINTAIN A GAS MAIN OR MAINS, IN  
UNDER, AND THROUGH THE PRIVATE ROADS, PATHS, WALKS, ALLEYS, PARKS,  
PLAYGROUNDS, AND TENNIS COURTS.

## LEGEND

- = SET IRON REBAR STAKE
- = FOUND IRON PIPE STAKE
- = FOUND CONCRETE COUNTY MONUMENT
- (XXX) = RECORDED AS

NOTE: COPIES OF THIS MAP TO WHICH THE FOLLOWING CERTIFICATE WILL APPLY SHOW  
THE SURVEYOR'S ORIGINAL SEAL AND SIGNATURE IN RED INK. COPIES BY ANY OTHER  
MEANS MAY HAVE ALTERATIONS WHICH DO NOT REPRESENT THE SURVEYOR'S WORK  
PRODUCT.

I HEREBY CERTIFY THAT THE ABOVE DESCRIBED PROPERTY HAS BEEN SURVEYED UNDER  
MY DIRECTION AND THAT THE ABOVE MAP IS A TRUE REPRESENTATION THEREOF AND  
SHOWS THE SIZE AND LOCATION OF THE PROPERTY, ITS EXTERIOR BOUNDARIES, THE  
LOCATION OF ALL VISIBLE STRUCTURES, AND DIMENSIONS OF ALL PRINCIPLE  
BUILDINGS THEREON, BOUNDARY FENCES, APPARENT EASEMENTS, ROADWAYS, AND  
VISIBLE ENCROACHMENTS, IF ANY. THIS SURVEY IS MADE FOR THE USE OF THE  
PRESENT OWNERS OF THE PROPERTY, AND ALSO THOSE WHO PURCHASE, MORTGAGE, OR  
GUARANTEE THE TITLE THERETO WITHIN ONE YEAR FROM THE DATE HEREOF.

DATED: NOVEMBER 1, 2005

PETER S. GORDON

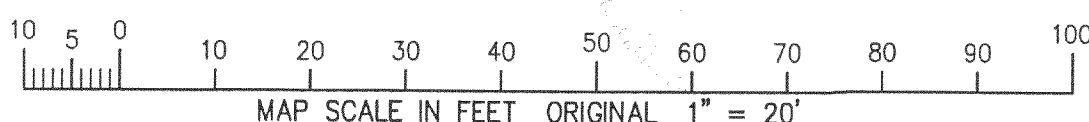

FOUND IRON PIPE  
STAKE N 05°37' E,  
0.52' FROM  
CORNER

KALE ROAD

S. 1/4 CORNER  
SECTION 21-2-17

FOUND IRON PIPE STAKE  
N 03°32' W, 1.36' FROM  
CORNER

FOUND IRON PIPE STAKE  
S 57°18' W, 0.76' FROM  
CORNER

TAX PARCEL JLCB-2082  
10,011 S.F. (0.23 AC.)

SANITARY  
MANHOLE

40' WIDE R.O.W.

DAHLIA DRIVE

40' WIDE R.O.W.

OVERHEAD  
POWER LINES

WOOD FENCE

WOOD FENCE

JUTE ROAD

TAX PARCEL JLCB-1294  
21,656 S.F. (0.50 AC.)

TAX PARCEL JLCB-1296  
8,011 S.F. (0.18 AC.)

JLCB-1294 JLCB 2082  
JLCB-1296

217-3142

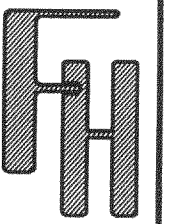

— WORK ORDERED BY —  
JAN SERAK  
C/O ELTON G. & OLGA V. KRAFT REV. TRUST  
6900 HORIZON DRIVE  
GREENDALE, WI 53129

FARRIS, HANSEN & ASSOCIATES, INC.  
ENGINEERING — ARCHITECTURE — SURVEYING  
7 RIDGWAY COURT P.O. BOX 437  
ELKHORN, WISCONSIN 53121  
OFFICE: (262) 723-2098 FAX: (262) 723-5886

## REVISIONS

PROJECT NO.  
6910  
DATE:  
11/01/05  
SHEET NO.  
1 OF 1